

SECTION B-B

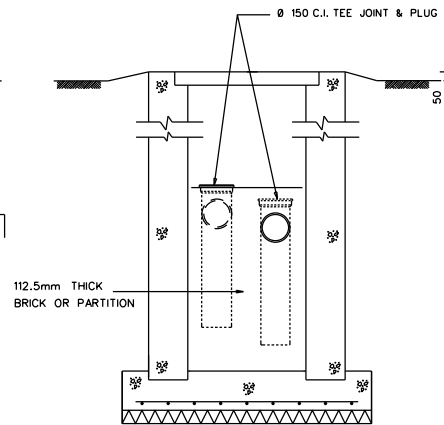

SECTION C-C

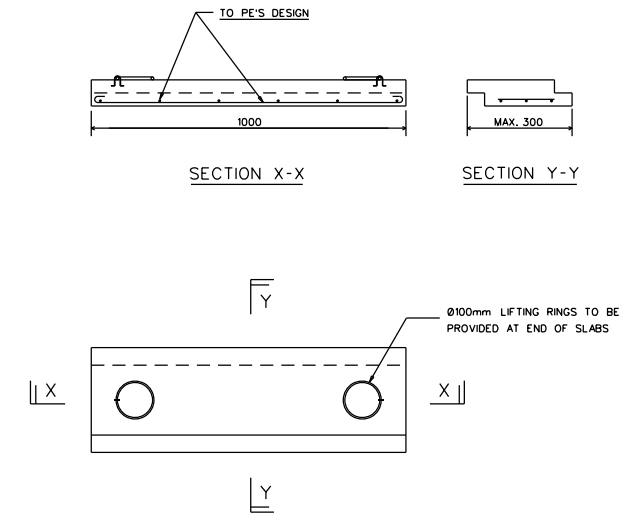

PLAN
PRECAST CONCRETE SLAB
SCALE : 1:10

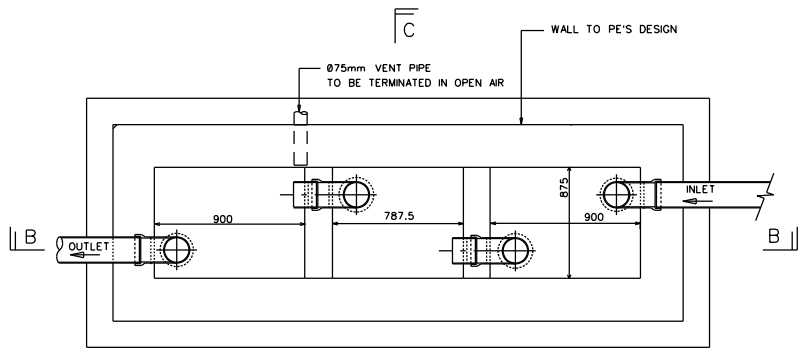

PLAN A-A

NOTES

1. THE INLET AND OUTLET PIPE AND PRE-CAST CONCRETE SLAB MUST BE DESIGNED TO WITHSTAND VEHICULAR LOADING. PRE-CAST CONCRETE SLAB MAY BE REPLACED WITH CHEQUERED PLATE TO SS30.
2. RAIN WATER SHALL BE PREVENTED FROM ENTERING INTO THE INTERCEPTOR.
3. IT IS THE RESPONSIBILITY OF THE OWNER TO MAINTAIN THE INTERCEPTOR REGULARLY SO AS TO ENSURE THAT DISCHARGE TO THE SEWER SHALL CONTAIN NO MORE THAN 60mg/l OF PETROL, GREASE OR OIL.
4. OIL, SILT ETC. COLLECTED IN THE INTERCEPTOR SHALL BE REGULARLY REMOVED AND DISPOSED OF ONLY BY LICENSED WASTE COLLECTOR.
5. UNLESS OTHERWISE STATED, ALL CONCRETE GRADE SHALL BE MINIMUM C28/35.
6. REINFORCED CONCRETE STRUCTURES TO PE'S DESIGN.
7. FLOW RATE SHALL NOT EXCEED 2.6 LITER/SECOND.

ALL DIMENSIONS ARE IN mm.

ISSUED : DEC 2021	SCALES
LAST REVIEWED : NOV 2021	1 : 30 UNLESS OTHERWISE STATED

STANDARD OIL INTERCEPTOR

OPUB SINGAPORE'S NATIONAL WATER AGENCY
 WATER RECLAMATION (NETWORK) DEPARTMENT
 DRG. NO. PUB/WRN/STD/042B

ORIGINAL BORDER SIZE 575mm x 400mm