

PLAN

PLAN

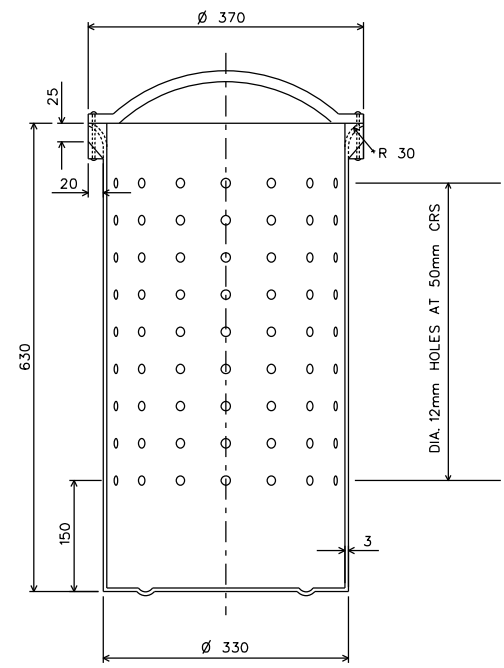

SECTION A - A

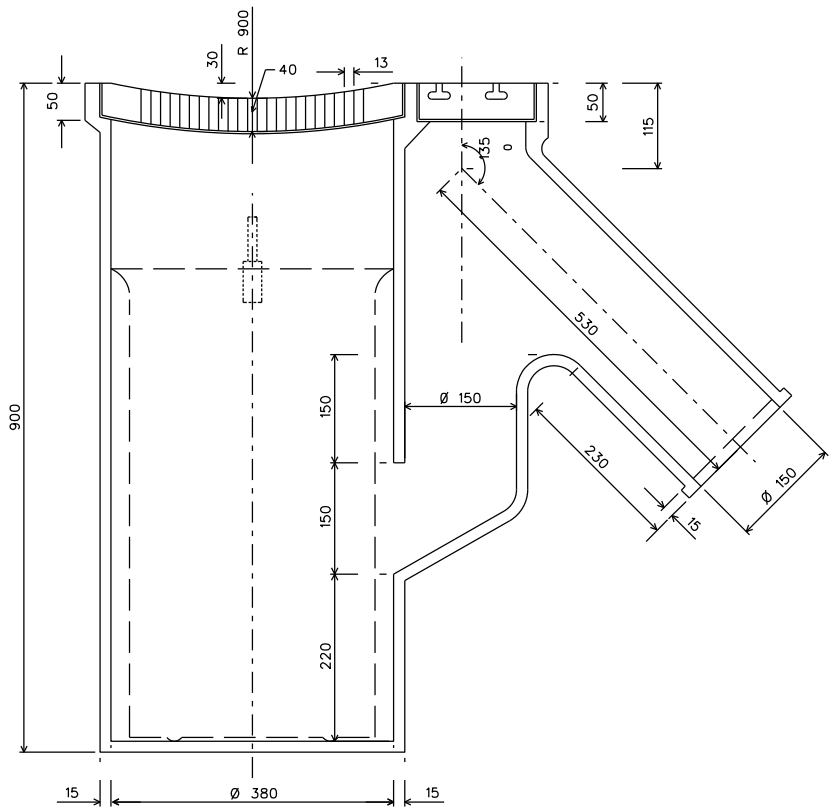

SECTION B - B

ALUM. ALLOY STRAINER BUCKET

C.I. GULLY TRAP

NOTES:

1. THE CAST IRON GULLY SHALL BE CAST FROM A MIXTURE OF CAST IRON SCRAP AND A SUITABLE GRADE OF PIG IRON. THE MIXTURE OF THE RESULTANT METAL SHALL BE SUCH AS TO PROVIDE A STRONG STRUCTURE FREE FROM CHILL.
2. THE CASE IRON GULLY SHALL BE FREE FROM AIRHOLES, SANDHOLES, COLD SHUTS AND CHILLS. THEY SHALL BE NEATLY DRESSED AND CAREFULLY FETTLER. ALL CASTING SHALL BE FREE FROM VOIDS WHETHER DUE TO SHRINKAGE, GAS INCLUSION OR OTHER CAUSES.
3. THE FINISHED PRODUCT SHALL BE SUPPLIED COATED WITH A BLACK BITUMINOUS COMPOSITION.
4. THE SPIGOT & SOCKET END OF THE GULLY SHALL COMPLY WITH THE CURRENT B.S. EN877.
5. THE ALUMINIUM ALLOY STRAINER IS TO COMPLY WITH B.S. ALLOY HE 30 TF OR SIMILAR STANDARD ALLOY.
6. THICKNESS OF THE C.I. GREASE INTERCEPTOR TO BE MINIMUM 15mm.

A TO COMPLY WITH B.S. EN877
AMENDMENTS

ISSUED : APR 2005	SCALES
REVIEWED : JAN 2019	1 : 5

STANDARD ALUM. ALLOY STRAINER BUCKET AND C. I. GULLY TRAP